

VENUS S/M

DATASHEET | SPECIFICATIONS



TECHNICAL SPECIFICATIONS

ELECTRICAL PARAMETERS

Light source	» LED
Power voltage	» AC 230 V / 50 Hz
Connection method	» terminal block » cable out + Gesis (on request)
Ballast part	» electronic driver
Possibility of regulation	» non-dimmable (not labeled) » corridor function (EPS-C) » DALI (DALI)
Emergency module	» NO

LIGHT PARAMETERS

Optical system	» wide beam (C40, C60)
Light distribution	» direct
Color rendering index	» Ra > 80
Color temperature	» 4 000 K
Service life	» > 90 000 hrs. (L80B10)

CONSTRUCTION

Luminaire body	» powder-coated steel sheet
Colour	» RAL 9007
Surface type	» matte
Luminaire cover	» safety glass

SAFETY

Protection class	» I
Maximum ambient temperature	» -5 / +40 °C
Electrical part protection	» IP 66
Optical part protection	» IP 66
Mounting on normally flammable materials	» YES

MOUNTING

Method	» suspension
Recommended height	» from 5 to 20 m

ACCESSORIES

Clips	» NO
Suspension accessories	» suspension hook

CHARACTERISTIC

Highly effective LED luminaire with long service life for wide-spectrum usage.

USE

industrial areas

warehouses

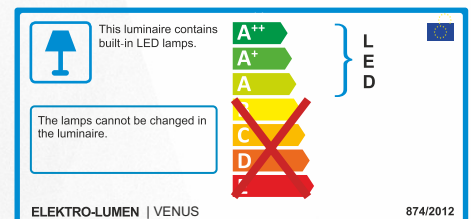

LIGHT DISTRIBUTION CURVE

VENUS M C40 23k5 840

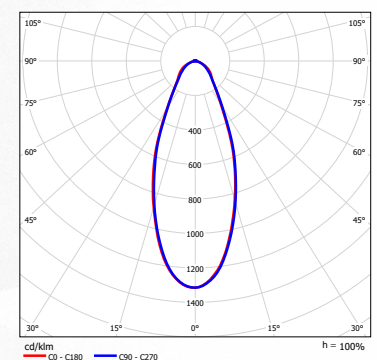

VARIANTS

DATASHEET VENUS S/M

TYPE	POWER	LUMINOUS FLUX	COLOR TEMPERATURE	SERVICE LIFE	WEIGHT
Catalog name	Watt (W)	Lumen (lm)	Kelvin (K)	L80B10 (hrs.)	Kilogram (kg)
VENUS S ... 8k8 840	80	8 800	4 000	> 90 000	6,5
VENUS S ... 11k8 840	119	11 800	4 000	> 90 000	6,5
VENUS M ... 17k4 840	150	17 400	4 000	> 90 000	9,5
VENUS M ... 23k5 840	198	23 500	4 000	> 90 000	9,5

Optical and electrical parameters tolerance $\pm 10\%$

LEGEND

VENUS S C40 11k8 840

	name
	optical system
	luminous flux 11 800 lm
	color rendering index Ra > 80, color temperature 4 000 K

DIMENSIONS

VENUS S

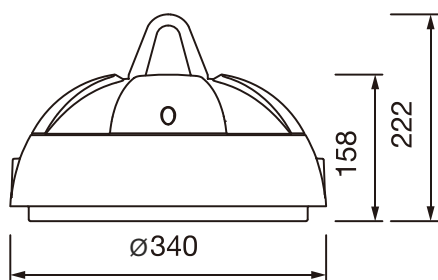

VENUS M

