

TEKO Park

DATASHEET | SPECIFICATIONS



TECHNICAL SPECIFICATIONS

ELECTRICAL PARAMETERS

Light source	» LED
AC voltage	» AC 220–240 V / 50–60 Hz
Connection	» leading out cable » leading out cable with connector (G)
Driver	» electronic driver with surge protection L/N-Ground 10 kV
Surge protection	» additional surge protection 10 kV (S)
Fuse	» fuse 6,3 A (J)
Dimming	» non-dimmable (not labeled) » DALI (max. 3 core cable) » night dimming (A) » preparation for wireless communication » NEMA (N) » Zhaga (Z)
Constant lumen output	» CLO (C)

LIGHT PARAMETERS

Optical system	» roads (Mxx) » roads (Lxx) » directional (Pxx) » AMBER modul (Nxx) » area (Uxx) » AMBER optics (Alxx) » BACK Light mask (BM2) » combined optics (Kxx)
Light distribution	» direct
Color rendering index	» Ra > 70 » Ra > 80
Color temperature	» AMBER » 2 200 K » 2 700 K » 3 000 K » 4 000 K » 5 000 K » TW
Service life	» > 120 000 hrs. (L90)

CONSTRUCTION

Housing	» aluminum cast
Color	» RAL 7015/9006 » other RAL (on request)
Surface	» matte
Cover	» tempered glass

SAFETY

Protection class	» I » II
Ambient operating temperature	» -40 / +55 °C
Ingress protection	» IP 66
Impact protection	» IK 09
EMC	» YES
Vibration test	» YES
Static load test	» YES
Corrosion test – Salty spray	» YES (1 500 hours)
Lifetime test	» YES
Certification	» ENEC+ » ENEC » Zhaga-D4i » IDA Dark Sky Approved
CB mark	» YES
RoHS	» YES
REACH	» YES

MOUNTING

Method	» pole (48–60 mm) » 60–76 mm (included)
Recommended height	» up to 6 m

CHARACTERISTIC

Modern gypsum LED lamp

USE

- Pedestrian zones
- Outdoor areas
- Sidewalks
- Cycle paths
- Square

- LED
- DIMM
AD
- DALI
- IP
66
- IK
09
- CB
- EMC
- Vibration

This luminaire contains built-in LED lamps.

The lamps cannot be changed in the luminaire.

ELEKTRO-LUMEN | TEKOP P 874/2012

LIGHT DISTRIBUTION CURVE

TEKO P U01 5k0 730 B124

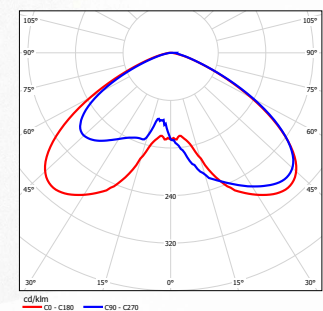

DIMENSIONS

TEKO P

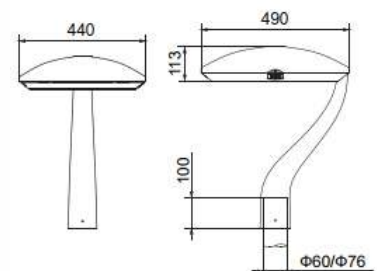

VARIANTS

DATASHEET TEKO P

VARIANTS chip (3535)	AMBER module			WARM WHITE 722			WARM WHITE 727			WARM WHITE 730			NEUTRAL WHITE 740			Luminaire efficiency (lm/W)	Kg**
	Power consumption	Luminaire output flux (lm)		Power consumption	Luminaire output flux (lm)		Power consumption (W)	Luminaire output flux (lm)		Power consumption (W)	Luminaire output flux (lm)		Power consumption (W)	Luminaire output flux (lm)			
		min	max		min	max		min	max		min	max		min	max		
TEKO P Mxx 2k0	16,4	1 684	1 796	16	1 734	1 849	13,9	1 634	1 742	13,9	1 734	1 849	12,6	1 677	1 789	142	9,9
TEKO P Mxx 3k0	27,2	2 501	2 667	23,4	2 501	2 667	20,9	2 501	2 667	19,6	2 551	2 720	18,3	2 551	2 721	149	9,9
TEKO P Mxx 4k0	39,8	3 334	3 556	33	3 392	3 618	28,1	3 334	3 556	26,8	3 426	3 654	24,3	3 337	3 560	146	9,9
TEKO P Mxx 5k0	50,9	4 226	4 507	43,4	4 234	4 516	35,5	4 134	4 409	33	4 151	4 427	31	4 184	4 463	144	9,9
TEKO P Mxx 6k0	61	5 001	5 334	44,4	5 018	5 352	45,5	5 093	5 432	41,1	4 984	5 316	38,3	5 030	5 365	140	9,9
TEKO P Mxx 7k0	75,6*	5 834	6 223	53,7	5 943	6 339	47	5 843	6 232	42	5 681	6 059	41,2	5 935	6 330	154	9,9
TEKO P Mxx 8k0	89,4*	6 668	7 112	63,5*	6 776	7 228	54,3	6 668	7 112	49,3	6 551	6 988	47	6 676	7 121	152	9,9
TEKO P Mxx 9k0	—	—	—	72,9*	7 493	7 992	63,3*	7 735	8 250	59,3	7 718	8 232	54,4	7 610	8 117	149	9,9
TEKO P Mxx 10k0	—	—	—	84,8*	8 477	9 041	69,9*	8 268	8 819	64,9*	8 302	8 854	61	8 368	8 926	146	9,9
TEKO P Mxx 12k0	—	—	—	—	—	—	84,9*	9 760	10 410	79*	9 914	10 575	74*	10 060	10 730	145	9,9

VARIANTS chip (5050)	AMBER optics			WARM WHITE 722			WARM WHITE 727			WARM WHITE 730			NEUTRAL WHITE 740				
TEKO P Lxx 2k0	12,5	1 261	1 484	—	—	—	12,5	1 636	1 754	12,5	1 712	1 835	12,5	1 813	1 944	156	9,9
TEKO P Lxx 3k0	17,5	1 824	2 146	—	—	—	18	2 479	2 658	17,5	2 479	2 658	17,5	2 623	2 812	161	9,9
TEKO P Lxx 4k0	23,1	2 433	2 864	—	—	—	24,5	3 314	3 553	23,1	3 302	3 540	23,1	3 500	3 752	162	9,9
TEKO P Lxx 4k0	28	2 938	3 458	—	—	—	31,1	4 187	4 489	30,6	4 318	4 629	28	4 225	4 530	162	9,9
TEKO P Lxx 6k0	34,1	3 506	4 127	—	—	—	38	5 060	5 425	35,9	4 975	5 334	34,1	5 043	5 407	159	9,9
TEKO P Lxx 7k0	26,9	4 093	4 818	—	—	—	41,3	5 861	6 283	39,6	5 903	6 329	36,9	5 886	6 311	171	9,9
TEKO P Lxx 8k0	44	4 867	5 729	—	—	—	46,4	6 628	7 106	46,4	6 949	7 450	44	6 999	7 504	171	9,9
TEKO P Lxx 9k0	48,7	5 377	6 329	—	—	—	53,7	7 607	8 155	51,2	7 632	8 182	48,7	7 733	8 291	170	9,9
TEKO P Lxx 10k0	53,5	5 875	6 916	—	—	—	59,5	8 374	8 978	58,5	8 635	9 258	53,5	8 450	9 059	169	9,9
TEKO P Lxx 12k0	65,2*	7 013	8 255	—	—	—	73,6*	10 111	10 840	68,7*	9 951	10 668	65,2*	10 086	10 813	166	9,9

* Can not be produced under ENEC licence

** Weight may vary depending on the luminaire variant

Luminaire ambient temperature TQ 25 °C

Initial color consistency: ≤ 5 SDCM

IDA fixture seal of approval relates to ≤ 3 000 K

To meet IDA requirements, the luminaires must be installed horizontally with the road

Optical and electrical parameters tolerance ± 10 %

When using the CLO function, the initial power and luminous flux is 10 % lower than the value shown in the table. LDT curves with CLO function have the letter "C" at the end of their marking.

The term AMBER in lighting technology refers to light with a minimum amount of the blue part of the light spectrum.

AMBER module - the light emitted from the LED chips on the module is already free of the blue part of the light spectrum (standard PMMA optics).

AMBER optics - the optical system absorbs the blue part of light from the LED module and transmits the remaining light spectrum (special AMBER optics).

CODE DESCRIPTION

TEKO	P	TW	II	M01	8k0	730	B124	43CAZ	SJG	H3S	ENEC			
													Name	
													TW	Tunable White
													Class	
													Without marking	Class I
													II	Class II
													Optical system	
													M01	Roads
													L01	Roads
													P01	Directional
													U01	Area
													K01	Combined optics
													AL01	Communication, AMBER optics
													K01	Communication, AMBER module
													BM02	Back light mask
													Luminous flux marking (source)	
													Ra 70 / 3 000 K	
													LED module marking	
													B	LED module type
													1	
													2	
													4	Mask type
													Driver type	
													43	OSRAM 4DIM (DALI) + 3 pole terminal block
													4	OSRAM 4 DIM
													1	OSRAM 1DIM (none DALI)
													D	OSRAM DX – Dexal (for Zhaga connector)
													C	Constant luminous flux (CLO)
													A	AstroDim
													Z	ZHAGA connector, 4 pin (Dexal driver)
													N	NEMA connector, 7 pin (4 DIM driver)
													S	Surge protection 10 kV
													J	Fuse 6,3 A
													G	Gesis connector
													H	H05(07)RN-F cable (1 mm ²)
													C	CYKY cable (1,5 mm ²)
													2	2 core cable
													3	3 core cable
													S	Standard – 25 cm length of cable (led out of the luminaire)
													1	1 meter (length in whole meters)
													ENEC certification	